

EPOXY TERRAZZO MATRIX W/
MARBLE CHIPS, GLASS CHIPS
OR OTHER AGGREGATE AS
SPECIFIED

BONDING AGENT/
EPOXY PRIMER

MOISTURE
VAPOR PRIMER

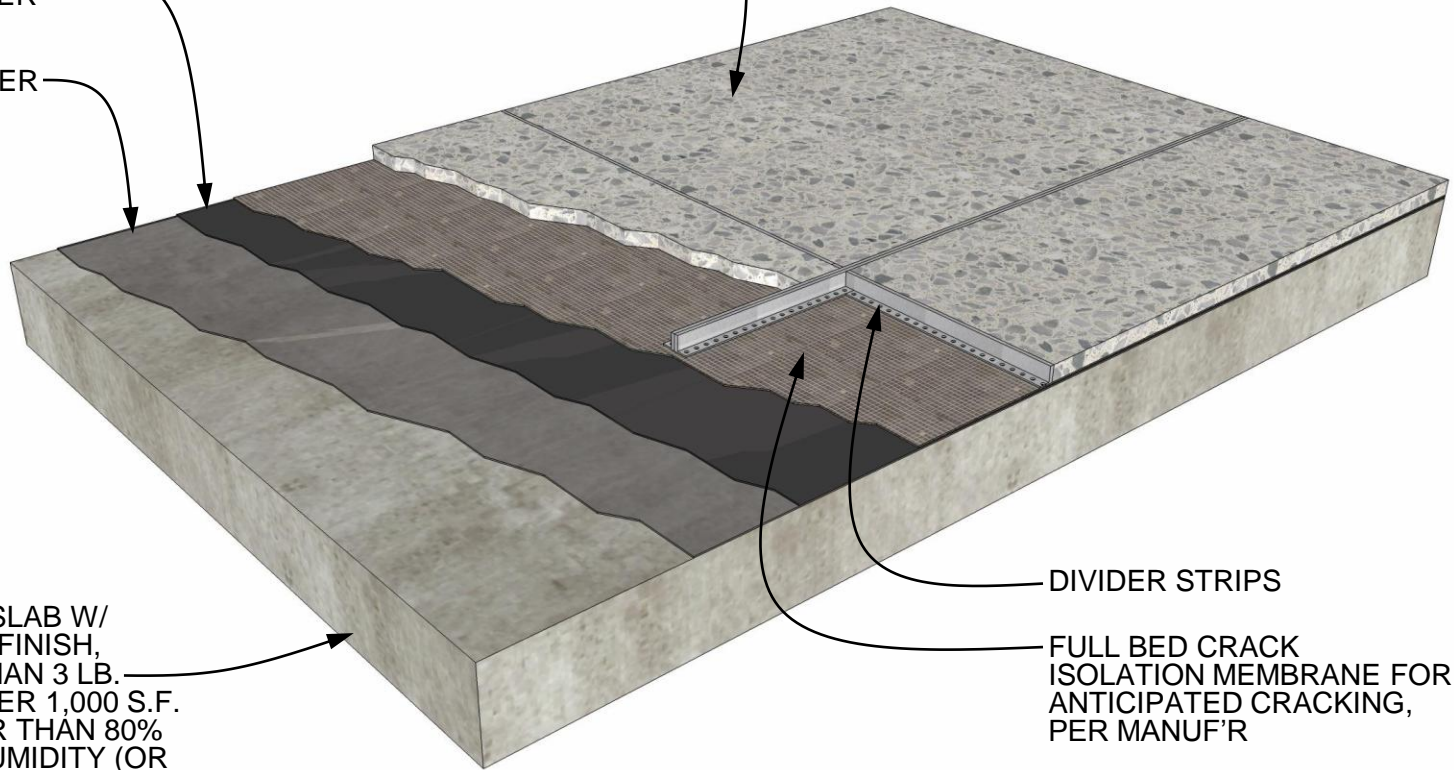

CONCRETE SLAB W/
SHOTBLAST FINISH,
GREATER THAN 3 LB.
MOISTURE PER 1,000 S.F.
OR GREATER THAN 80%
RELATIVE HUMIDITY (OR
PER MANF'R), AND HIGH
POTENTIAL FOR CRACKING

DIVIDER STRIPS

FULL BED CRACK
ISOLATION MEMBRANE FOR
ANTICIPATED CRACKING,
PER MANUF'R

EPOXY TERRAZZO

ON CONCRETE W/ MOISTURE
AND ANTICIPATED CRACKING

DETAIL 07.130.0104

REV. 01/31/11

International Masonry Institute



800-IMI-0988 www.imiweb.org

© 2010 INTERNATIONAL MASONRY INSTITUTE