

KEY NOTES

- 01 (E) Masonry backup, multi-wythe construction
- 11 Architectural terra cotta, hand pressed
- 21 Mortar
- 37 Stainless steel rod
- 38 Stainless steel strap and pin anchor
- 39 Stainless steel split tail anchor
- 40 Stainless steel strap anchor
- 51 Flashing system with end dams as required
- 52 Termination bar with continuous sealant
- 54 Stainless steel drip edge; seal and adhere to substrate
- 59 Weep vent
- 60 Weep hole at underside of each overhanging TC unit
- 72 Sealant and backer rod
- 74 Sealant or lead T-caps at all horizontal skyward-facing joints
- 75 Plastic setting shims as required
- 81 (E) Window assembly
- 86 Stainless steel J-bolt
- 94 (E) Structural steel treated with corrosion-inhibiting coating

GENERAL NOTES

This drawing references Lintel-Original Plate 36.

Where anchors penetrate flashing, seal with compatible sealant.

DELIMITATION

This detail exhibits rebuild strategies with hand pressed architectural terra cotta (TC). Other options may be appropriate. It is best to consult a professional team of engineers, architects, and architectural conservators when crafting a repair or rebuild scenario for historic architectural TC.

CONSIDERATIONS

- Architect/engineer to verify condition and soundness of existing (E) masonry backup. Perform testing as necessary.
- Rebuild or replace backup as necessary.
- Replacing anchors requires performing anchorage pull-testing.
- Accessible existing sound steel that is to remain, requires cleaning and coating with a corrosion inhibitor.
- Corroded steel to be evaluated and painted, repaired, or replaced with stainless steel based on condition
- Original TC units are to be replaced in-kind or removed, repaired, and reinstalled and not filled.
- Install new TC units not filled.
- Weep holes in units must be kept clear and free of mortar and debris to prevent trapping of moisture after installation.
- Design considerations include:
 - Tolerances
 - Shims
 - Shoring
 - Modifications to units
 - (E) Anchor removal

KEYWORDS

Terra cotta, Rebuild, Pressed, Hand pressed, Lintel, Brick, Restoration, Anchor, Repair, Window, Flashing, 10.030.0632

WJE

Developed in cooperation with Wiss, Janney, Elstner & Associates, Inc.

IMI INTERNATIONAL MASONRY INSTITUTE
TERRA COTTA DETAILING SERIES
© 2021 International Masonry Institute www.imiweb.org

TITLE

Lintel rebuild | Terra cotta, pressed

SCALE

None

REV.

02/01/21

INTERACTIVE MODEL

<https://imisketchupmodels.blogspot.com/2021/01/100300632-lintel-rebuild-terra-cotta.html>

SHEET NO.

10.030.0632

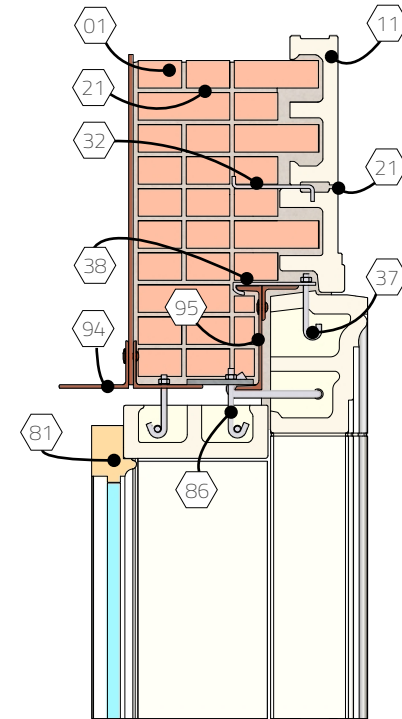
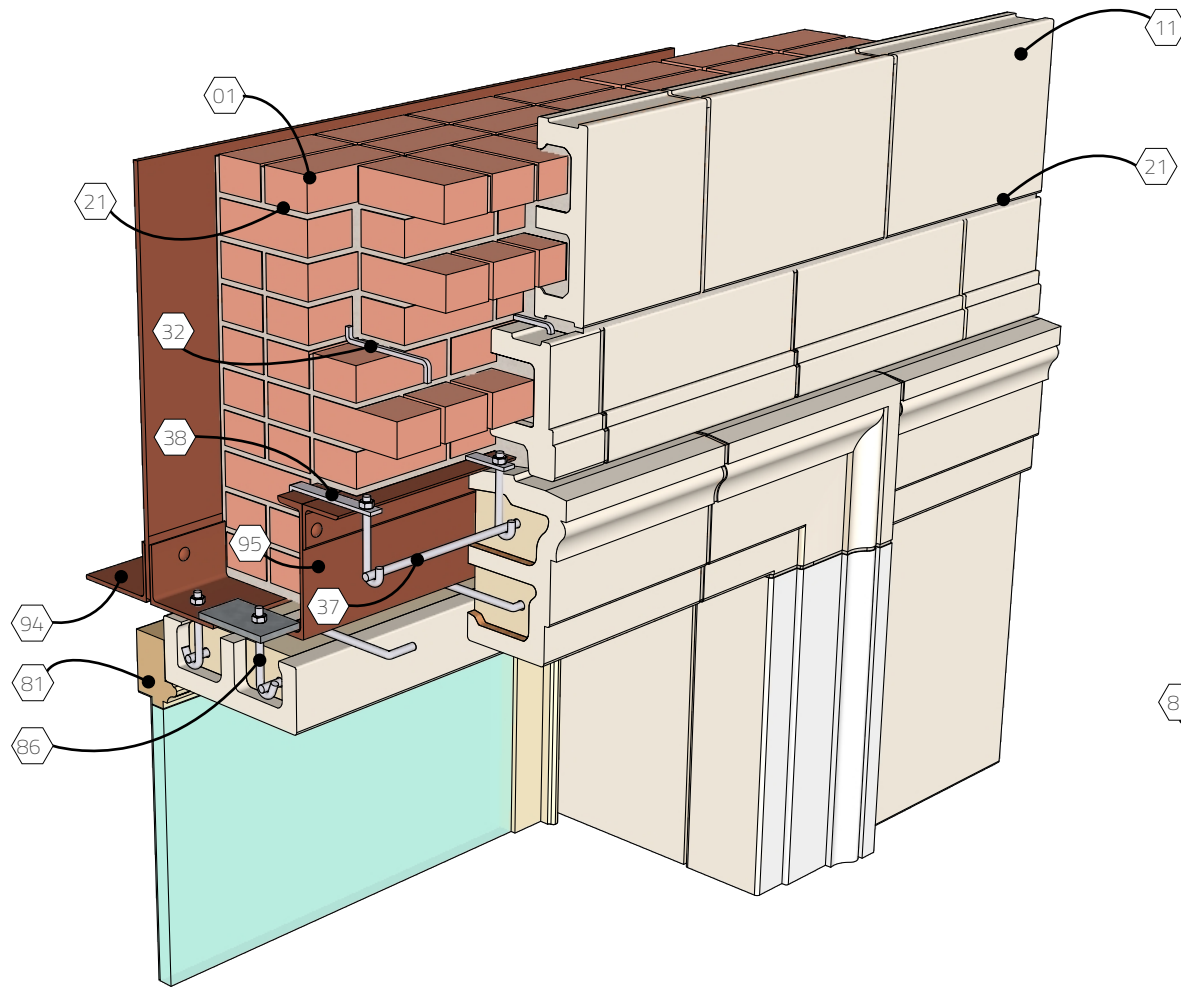

Section

KEY NOTES

- 01 Masonry backup, multiwythe construction
- 11 Architectural terra cotta, hand pressed
- 21 Mortar
- 32 Bent steel bar
- 37 Steel rod
- 38 Steel strap anchor
- 81 Window assembly
- 86 Steel J-hook
- 94 Steel angle
- 95 Steel channel

Note: This Terra Cotta Detail is a modern rendering of the original detail shown in Plate 36 of Terra Cotta Standard Construction, published by the National Terra Cotta Society in 1927.

KEYWORDS

Terra Cotta, Hand Pressed, Lintel, Brick, Restoration, Anchor, Window, Original Plate 36, 10.030.0631

TITLE

Lintel - Original Plate 36

SCALE

None

REV.

09/10/20

SHEET NO.

10.030.0631