

**KEY NOTES**

- 04 Dimension stone wall cladding
- 08 Light gauge steel stud framing
- 19 Anchoring plate
- 27 Gypsum board
- 33 Z-strap anchor
- 36 Kerf
- 77 Bearing pad, plastic or non-compressible rubber
- 78 Shim as required

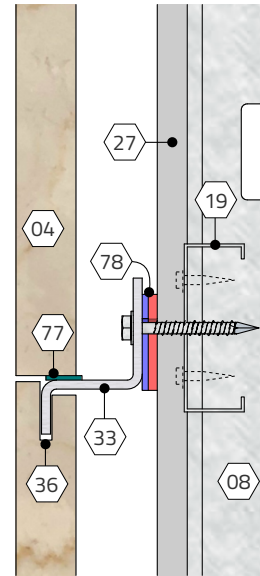
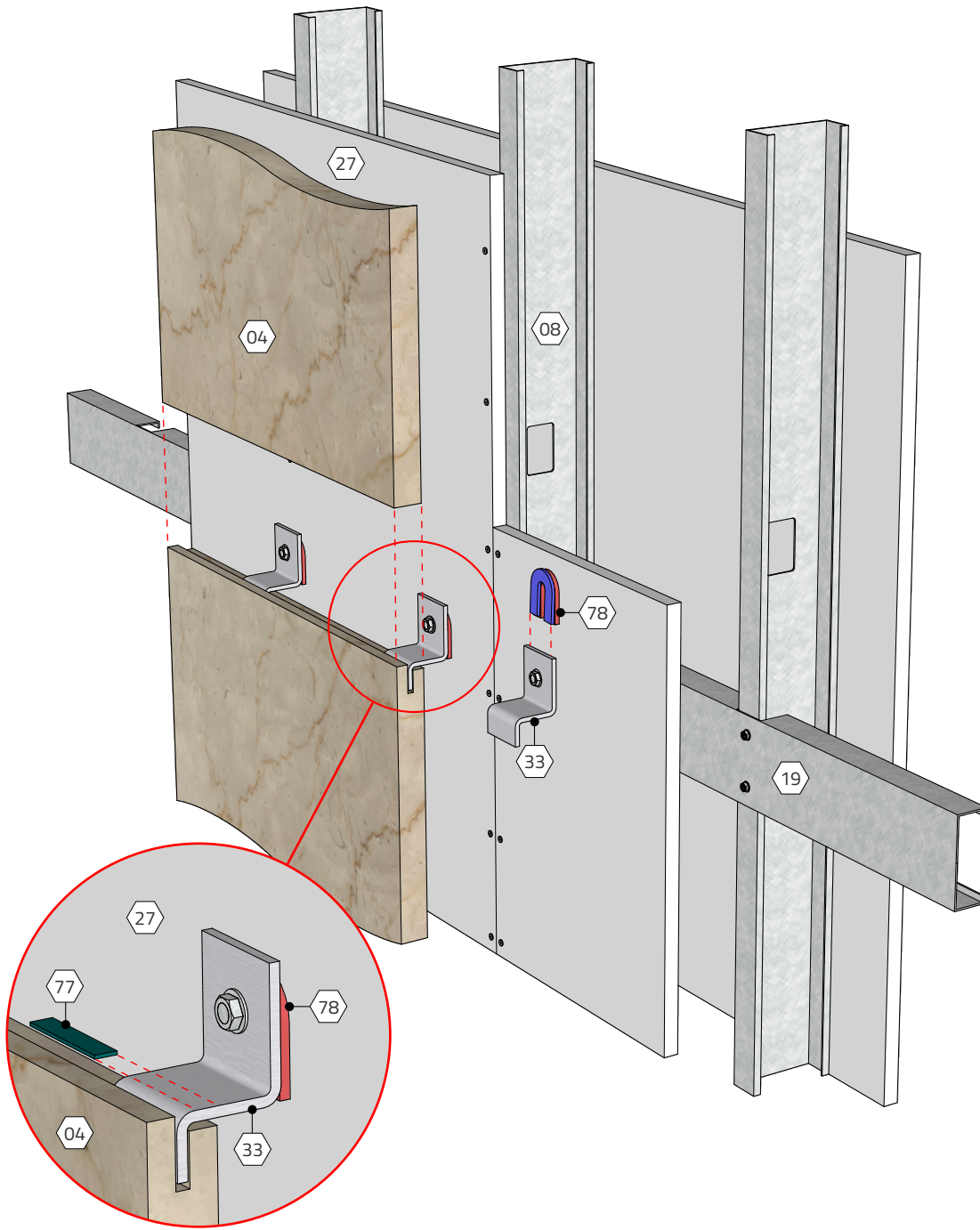

Section  
Scale: 3" = 1'-0"

**KEYWORDS**

Marble, Dimension stone, Interior, Walls, Z-strap anchor, 04.040.0203

TITLE  
Dimension stone wall, interior | Z-strap anchors

SCALE  
Noted

REV.  
11/18/22

SHEET NO.  
04.040.0203