

KEY NOTES

- 04 Dimension stone wall cladding
- 08 Light gauge steel stud framing
- 19 Anchoring plate
- 27 Gypsum board
- 36 Kerf
- 39 Split tail anchor
- 77 Bearing pad, plastic or non-compressible rubber
- 78 Shim as required

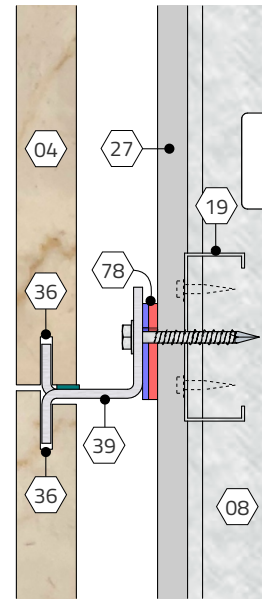
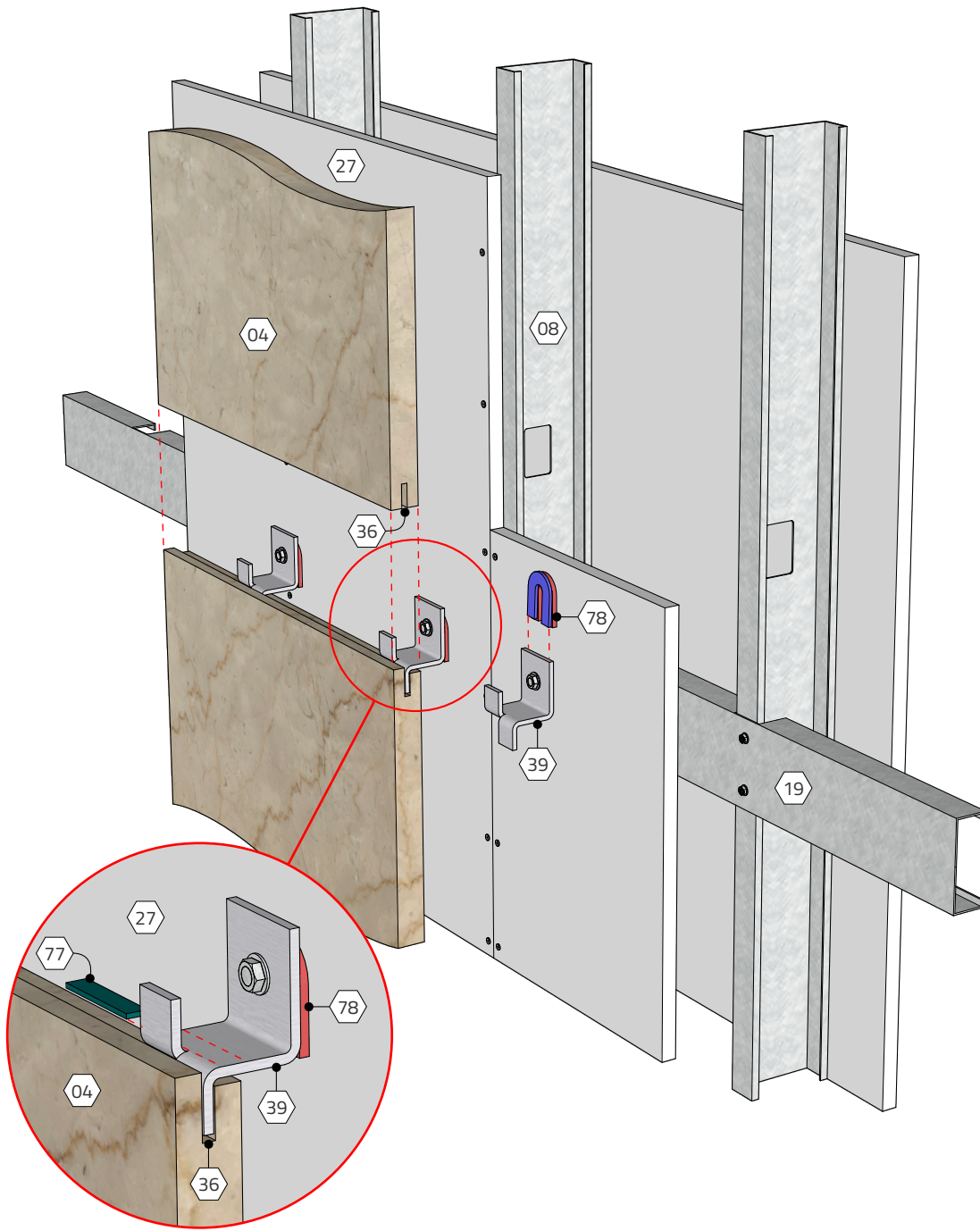

Section
Scale: 3" = 1'-0"

KEYWORDS

Marble, Dimension stone, Interior, Walls, Split-tail anchor, Kerf anchor, 04.040.0201

TITLE

Dimension stone wall, interior | Split-tail anchors

SCALE

Noted

REV.

11/18/22

SHEET NO.

04.040.0201