

Stop grout 1 1/2 in. from top of pour to create grout key

Grout in bond beams & reinforced vertical cells placed in top of wall after wall has been laid up

Vertical reinforcement for closed-end concrete masonry units can be set after wall has been laid

Rebar positioner, wall tie, or other device to position vertical reinforcement, as required

Bond beam option 2: Standard CMU w/ cross webs knocked out

Horizontal reinforcement placed in bond beams as wall is laid up

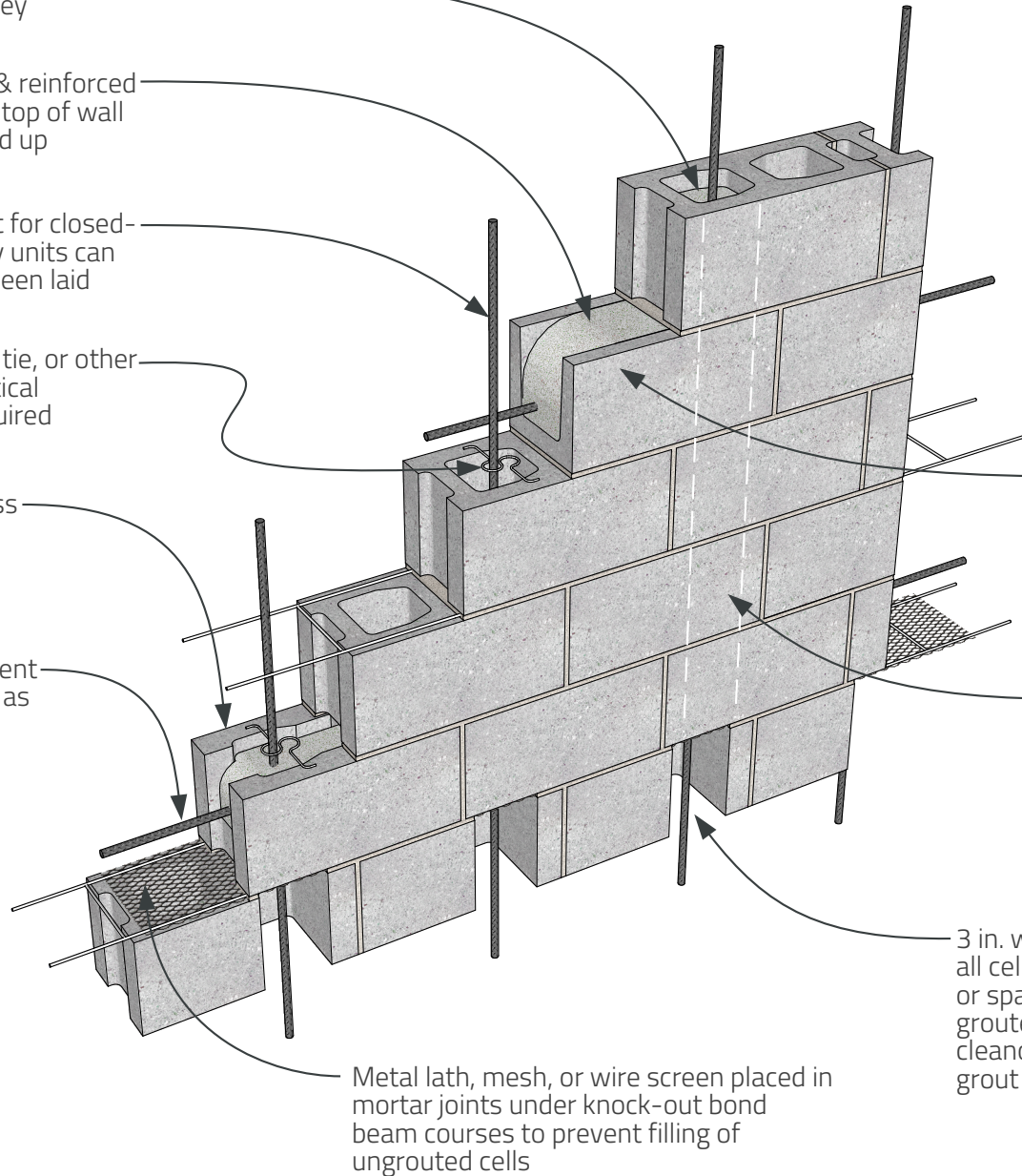

Note: High lift grouting procedures apply to grout placed in pours and lifts exceeding 5'-4" and not to exceed 12'-8"

Bond beam option 1: U-block units w/ solid bottom

Vertical cells containing reinforcement are filled solid with grout; Cells should provide a continuous cavity, free of mortar droppings

3 in. wide min. cleanout openings at all cells with vertical reinforcement, or spaced 32" o.c. max. for fully grouted walls; Close and brace cleanouts prior to grouting to resist grout pressure

Metal lath, mesh, or wire screen placed in mortar joints under knock-out bond beam courses to prevent filling of ungrouted cells

TITLE

High Lift Grouting Procedures

REV.

08/31/22

SHEET NO.

02.410.0132

Detail No.	Title	Description	Embed Code for 3D Warehouse Model	Interactive model on IMI Models Blog
01.410.0131	Low lift grouting procedures	<p>This diagram illustrates low lift grouting procedures in the field of the wall. Vertical bars are spaced per structural design and reinforced cells are filled solid with grout. Horizontal bond beams are also spaced per design, and can be formed with standard open-cell CMU with cross webs knocked out to accommodate horizontal bar(s) and grout stop material below; or they can be constructed with solid-bottom U-block units notched to accommodate intersecting vertical bars. Low lift grouting procedures apply to grout placed in pours and lifts not to exceed 5'-4". Details that show different or modified concepts or methods can be of equal validity and should not be excluded from consideration. This detail shall not be used for construction without the approval an signature of a licensed design professional. The person using this detail shall be responsible for its complete design and proper application.</p>	<pre><iframe src="https://3dwarehouse .sketchup.com/embed/02 092e05-7daa-4052-ab8a- a9fdb80324c8?token=mc S0f1oow6c=&binaryNam e=s22" frameborder="0" scrolling="no" marginheight="0" marginwidth="0" width="580" height="326" allowfullscreen></iframe></pre>	https://imisketchupmodels.blogspot.com/2022/08/014100131-low-lift-grouting-procedures.ht
ml 01.410.0132	High lift grouting procedures	<p>This diagram illustrates high lift grouting procedures in the field of the wall. Vertical bars are spaced per structural design and reinforced cells are filled solid with grout. Horizontal bond beams are also spaced per design, and can be formed with standard open-cell CMU with cross webs knocked out to accommodate horizontal bar(s) and grout stop material below; or they can be constructed with solid-bottom U-block units notched to accommodate intersecting vertical bars. All cells with vertical reinforcement require 3" wide min. cleanout openings to validate grout placement. High lift grouting procedures apply to grout placed in pours and lifts exceeing 5'-4" but not to exceed 12'-8". Details that show different or modified concepts or methods can be of equal validity and should not be excluded from consideration. This detail shall not be used for construction without the approval an signature of a licensed design professional. The person using this detail shall be responsible for its complete design and proper application.</p>	<pre><iframe src="https://3dwarehouse .sketchup.com/embed/01 8fb085-114a-405f-8b07- da6034679b88?token=g CnJ9FLyQ38=&binaryNa me=s22" frameborder="0" scrolling="no" marginheight="0" marginwidth="0" width="580" height="326" allowfullscreen></iframe></pre>	https://imisketchupmodels.blogspot.com/2022/08/014100132-high-lift-grouting-procedures.ht

[ml](#)