

CONCAVE

VEE

FLUSH

KEY WORDS

Mortar, Joints, Profiles,
Concave, Vee, Flush, Raked,
Beaded, Extruded, Squeezed,
Weeping, Skintled, Weathered,
Struck, Prism, Grapevine,
Tuckpointing, Repointing,
01.410.1001

MORTAR JOINT PROFILES

Detail 01.410.1001A Rev. 12/08/21

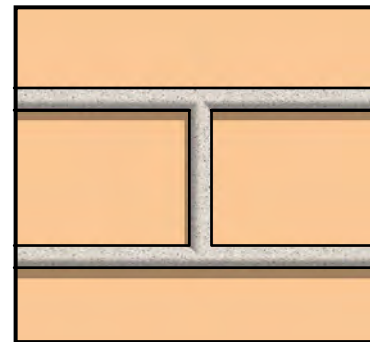
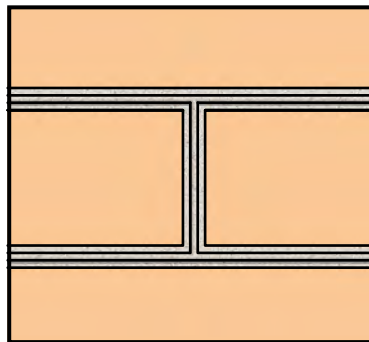
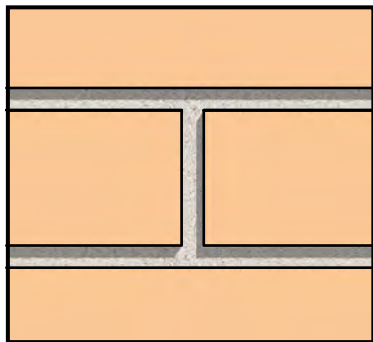
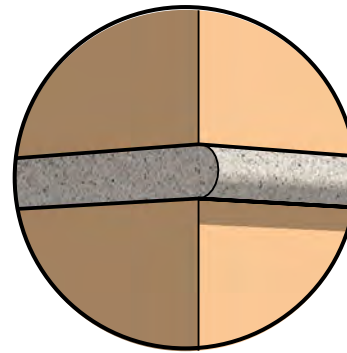
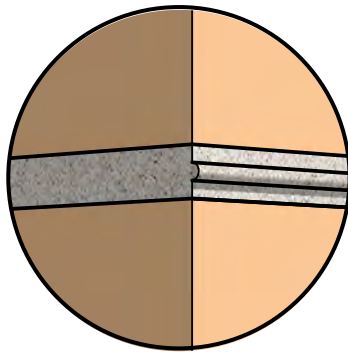
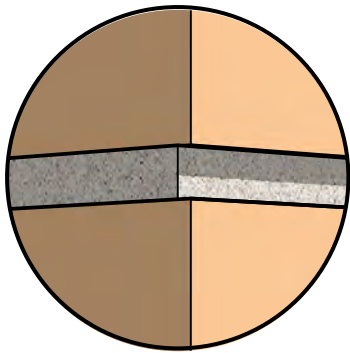
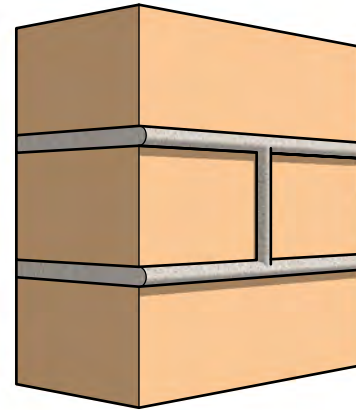
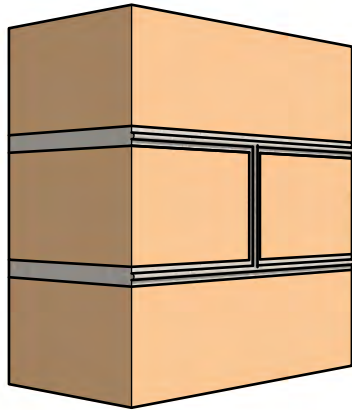
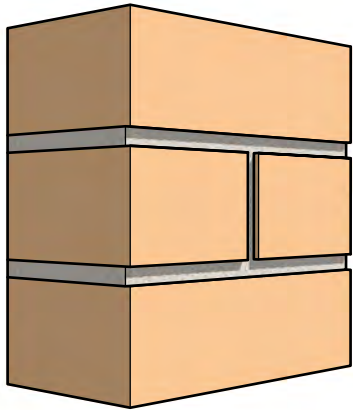

RAKED

BEADED
(narrow bead)

BEADED
(wide bead)

KEY WORDS

Mortar, Joints, Profiles,
Concave, Vee, Flush, Raked,
Beaded, Extruded, Squeezed,
Weeping, Skintled, Weathered,
Struck, Prism, Grapevine,
Tuckpointing, Repointing,
01.410.1001

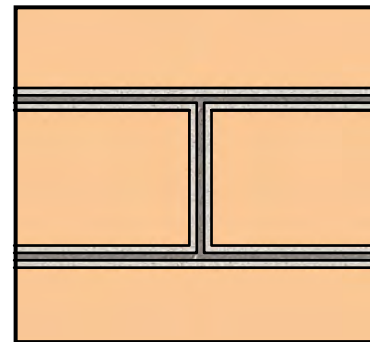
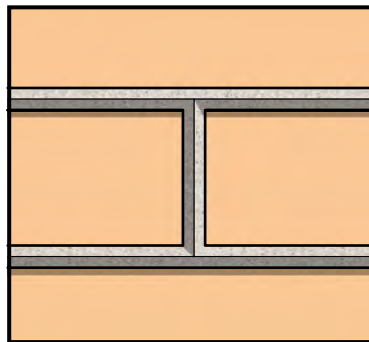
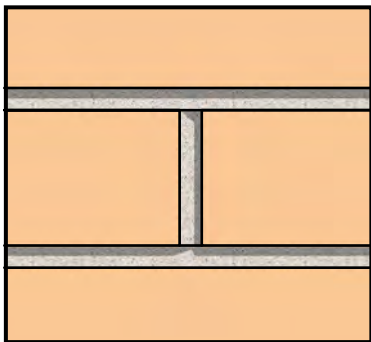
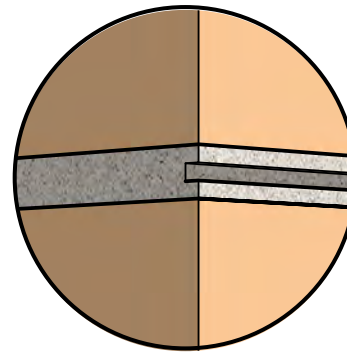
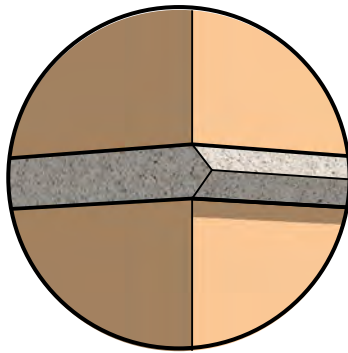
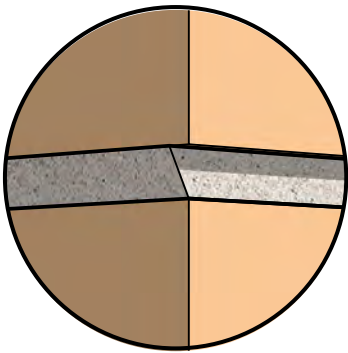
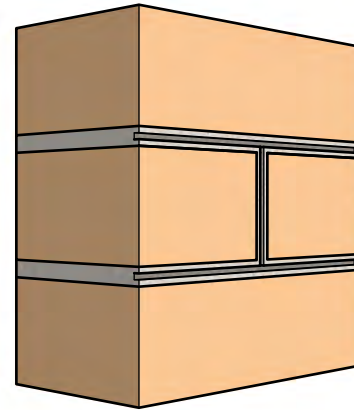
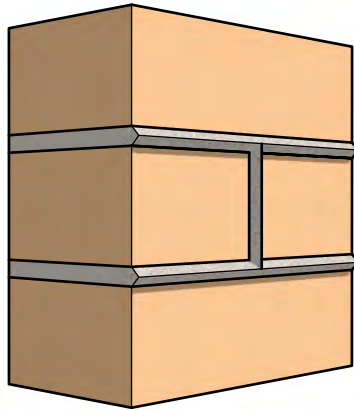
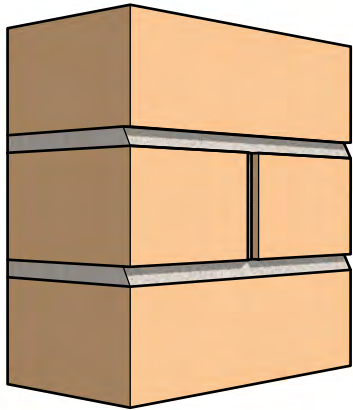

WEATHERED

PRISM

GRAPEVINE

KEY WORDS

Mortar, Joints, Profiles,
 Concave, Vee, Flush, Raked,
 Beaded, Extruded, Squeezed,
 Weeping, Skintled, Weathered,
 Struck, Prism, Grapevine,
 Tuckpointing, Repointing,
 01.410.1001

MORTAR JOINT PROFILES

Detail 01.410.1001C Rev. 12/08/21

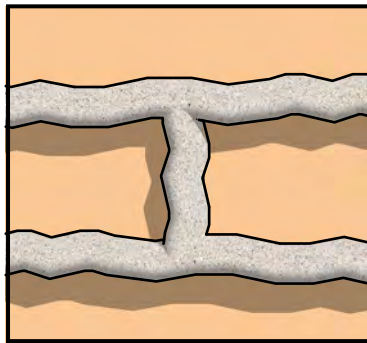
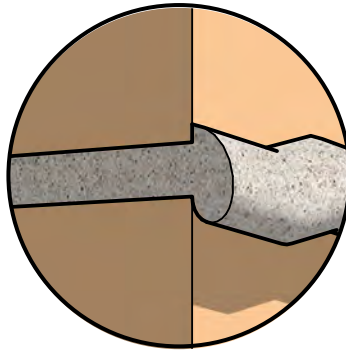
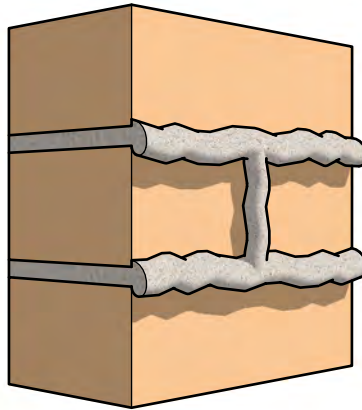

WEeping

AKA Extruded, Squeezed,
Skintled

KEY WORDS

Mortar, Joints, Profiles,
Concave, Vee, Flush, Raked,
Beaded, Extruded, Squeezed,
Weeping, Skintled, Weathered,
Struck, Prism, Grapevine,
Tuckpointing, Repointing,
01.410.1001

MORTAR JOINT PROFILES

Detail 01.410.1001D Rev. 12/08/21

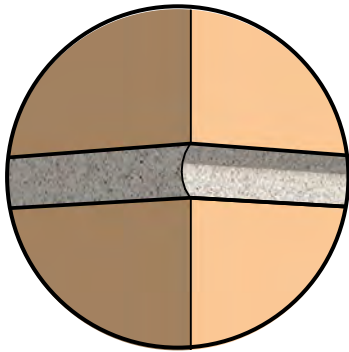

CONCAVE

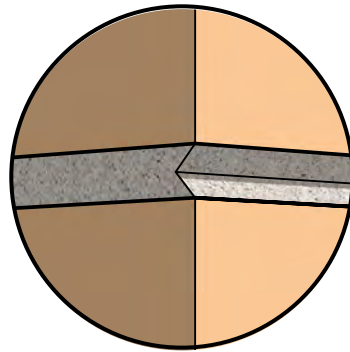

VEE

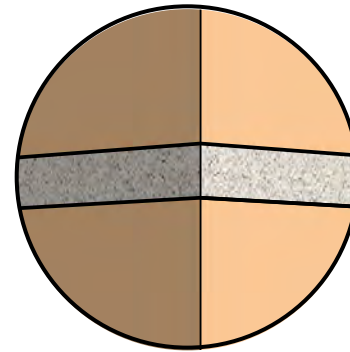

FLUSH

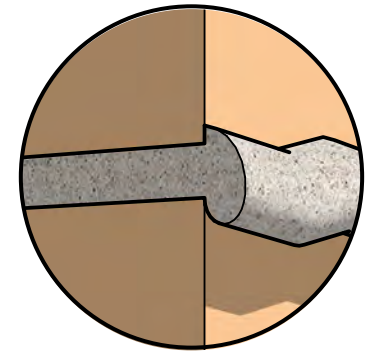

WEEPING
AKA Extruded, Squeezed,
Skintled

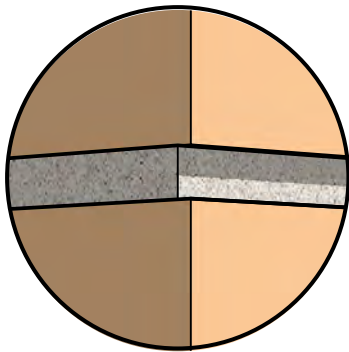

RAKED

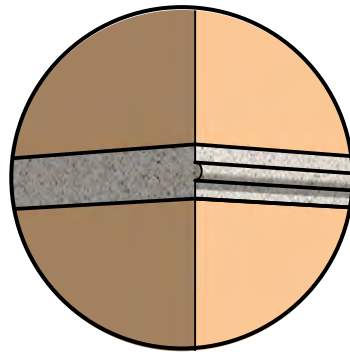

BEADED
(narrow bead)

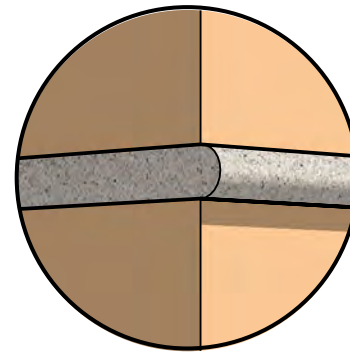

BEADED
(wide bead)

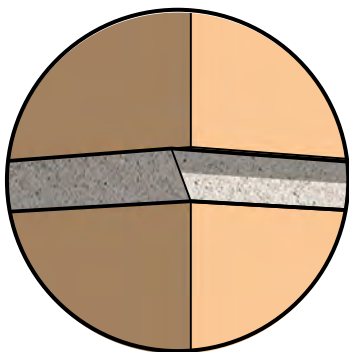

WEATHERED

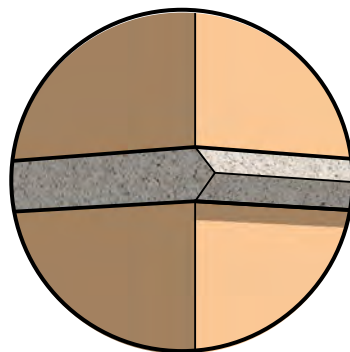

PRISM

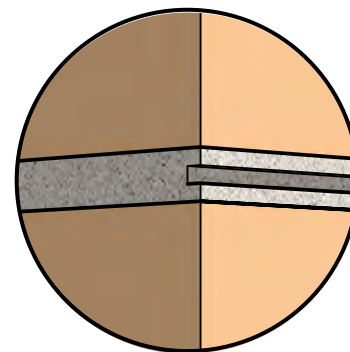

GRAPEVINE

KEY WORDS

Mortar, Joints, Profiles,
Concave, Vee, Flush, Raked,
Beaded, Extruded, Squeezed,
Weeping, Skintled, Weathered,
Struck, Prism, Grapevine,
Tuckpointing, Repointing,
01.410.1001

MORTAR JOINT PROFILES

Detail 01.410.1001E Rev. 12/08/21