

- METAL STUDS
- 2" AAC SHEATHING
- BONDING AGENT
- 3/8" BASE COAT
- 1/8" FINISH COAT (PROPRIETARY)

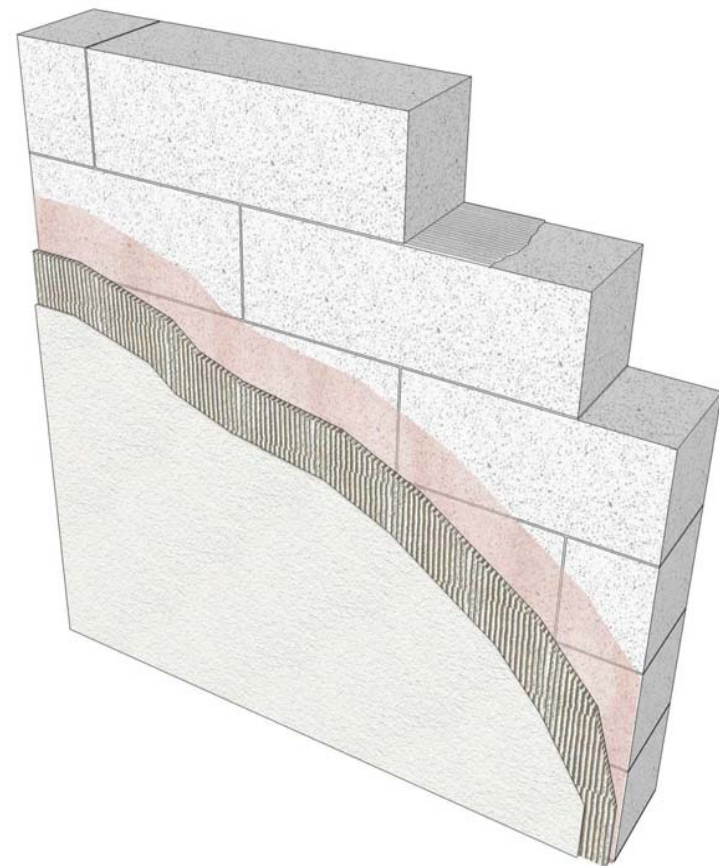

- 8" AAC BLOCK BACKUP
- BONDING AGENT
- 3/8" BASE COAT
- 1/8" FINISH COAT (PROPRIETARY)

## AAC EXTERIOR WALL TYPES

DETAIL 13.400.0104

REV. 11/20/07

International Masonry Institute



800-IMI-0988 [www.imiweb.org](http://www.imiweb.org)

© 2009 INTERNATIONAL MASONRY INSTITUTE