

GROUT &
REINFORCEMENT
AS REQ'D

1. DRILL INJECTION
PORTS IN BED JOINTS
@8" O.C. EXCEPT AT
GROUTED CELLS

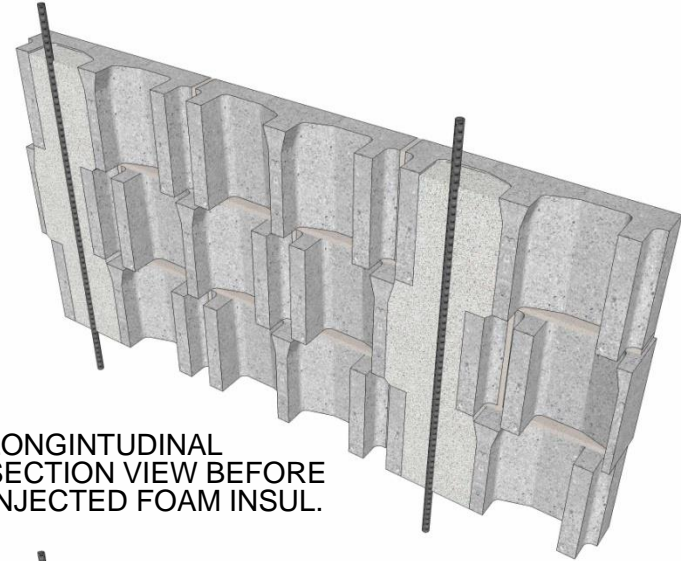

2. LONGINTUDINAL
SECTION VIEW BEFORE
INJECTED FOAM INSUL.

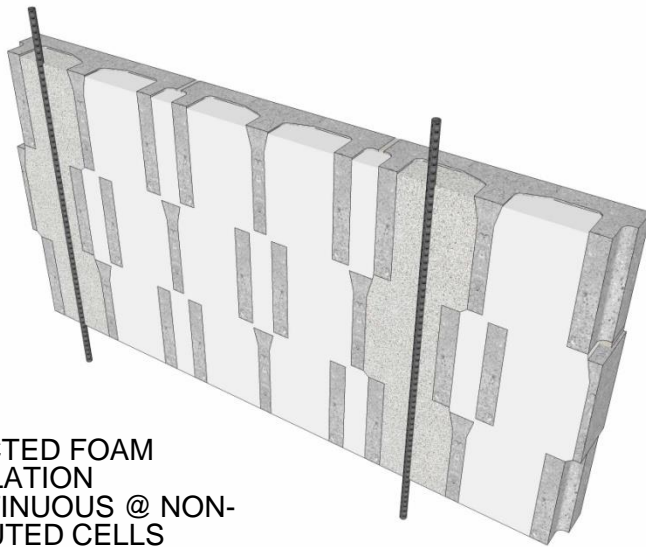

3. INJECTED FOAM
INSULATION
CONTINUOUS @ NON-
GROUTED CELLS

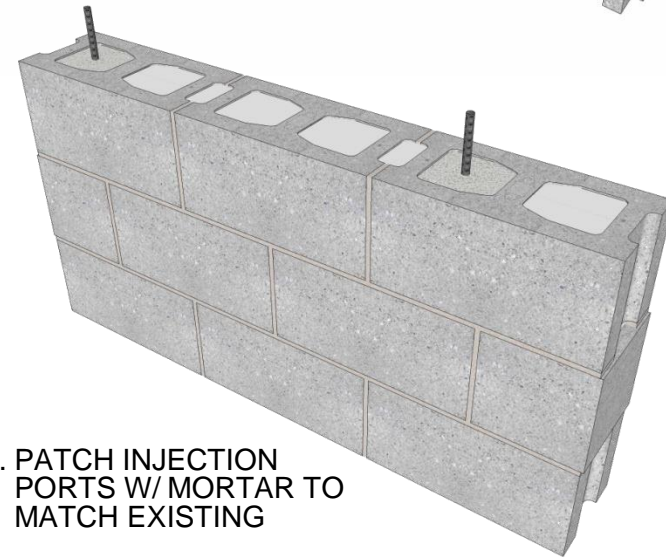

4. PATCH INJECTION
PORTS W/ MORTAR TO
MATCH EXISTING

INJECTED FOAM INSULATION

DETAIL 02.610.0201

REV. 12/13/08

International Masonry Institute



800-IMI-0988 www.imiweb.org

© 2011 INTERNATIONAL MASONRY INSTITUTE