

GROUT IN BOND BEAMS & REINFORCED VERTICAL CELLS PLACED IN TOP OF WALL AFTER WALL HAS BEEN LAID UP

VERTICAL REINFORCEMENT FOR CLOSED-END CONCRETE MASONRY UNITS CAN BE SET AFTER WALL HAS BEEN LAID.

REBAR POSITIONER, WALL TIE, OR OTHER DEVICE TO POSITION VERTICAL REINFORCEMENT, AS REQ'D.

HORIZONTAL REINFORCEMENT PLACED IN BOND BEAMS AS WALL IS LAID UP

NOTE: GROUT LIFTS NOT TO EXCEED 5 FT. SEE STRUCTURAL DWGS FOR MAX. HEIGHT OF POUR. MECH. CONSOLIDATE & RECONSOLIDATE GROUT

STOP GROUT 1" FROM TOP OF POUR TO CREATE SHEAR KEY

OPTION 1: U-BLOCK UNITS W/ SOLID BOTTOM AT BOND BEAM COURSE

CELLS CONTAINING REINFORCEMENT ARE FILLED SOLIDLY W/ GROUT; VERTICAL CELLS SHOULD PROVIDE A CONTINUOUS CAVITY FREE OF MORTAR DROPPINGS

CLEANOUT OPENINGS @ BASE OF VERTICALLY REINF. CELLS, 32" O.C. MAX. SPACING FOR SOLID GROUTED WALLS. REMOVE MORTAR DROPPINGS THROUGH CLEANOUTS AND VERIFY PLACEMENT & LOCATION OF VERTICAL REINF.; FORM OVER OPEN'GS BEFORE PLACING GROUT

OPTION 2: STANDARD CMU W/ CROSS WEBS KNOCKED OUT AT BOND BEAM COURSE

METAL LATH, MESH, OR WIRE SCREEN PLACED IN MORTAR JOINTS UNDER KNOCK-OUT BOND BEAM COURSES TO PREVENT FILLING OF UNGROUTED CELLS

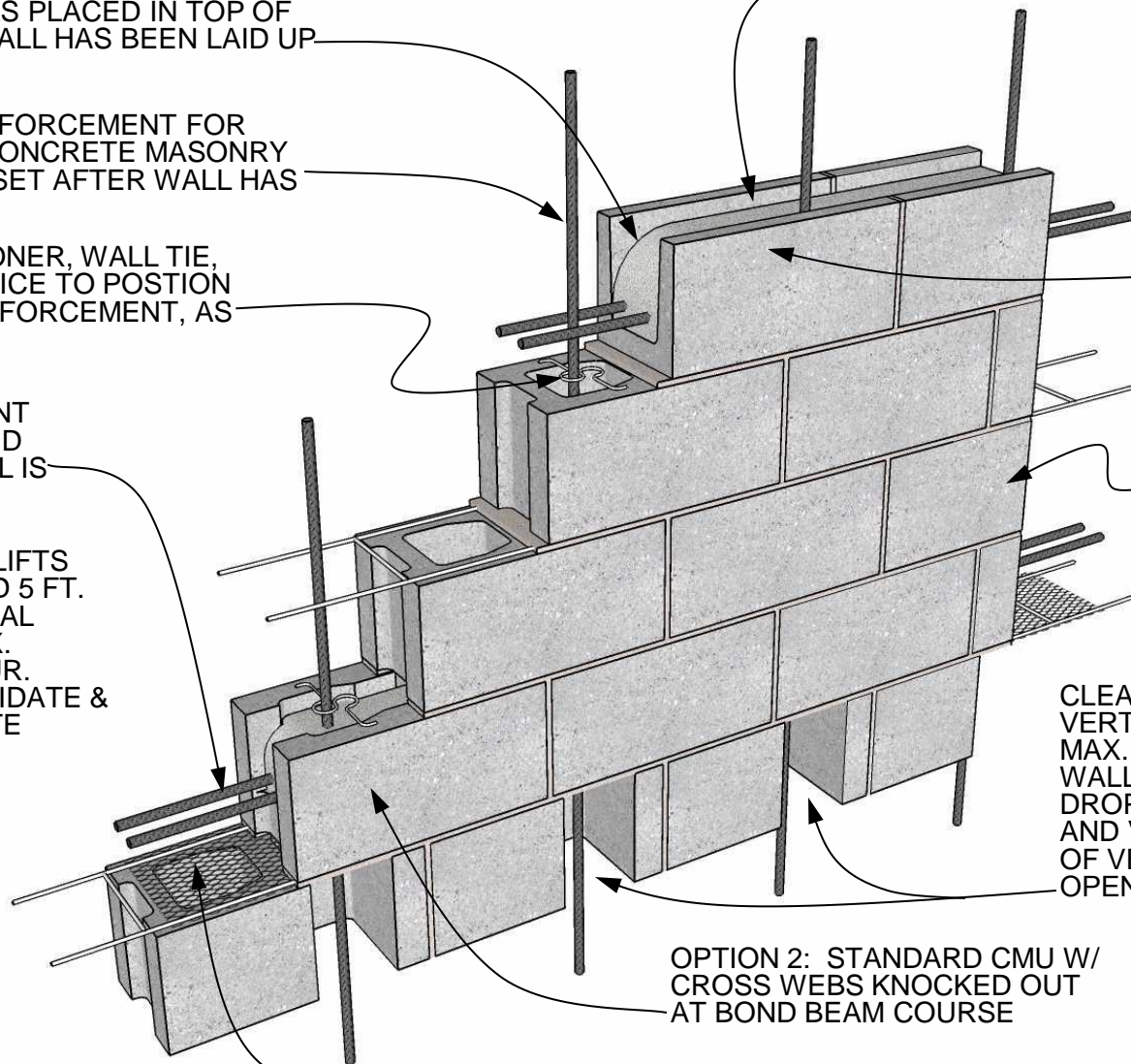

## HIGH LIFT GROUTING PROCEDURES

DIAGRAM 02.410.0132

REV. 07/06/10

International Masonry Institute



800-IMI-0988 [www.imiweb.org](http://www.imiweb.org)

© 2011 INTERNATIONAL MASONRY INSTITUTE