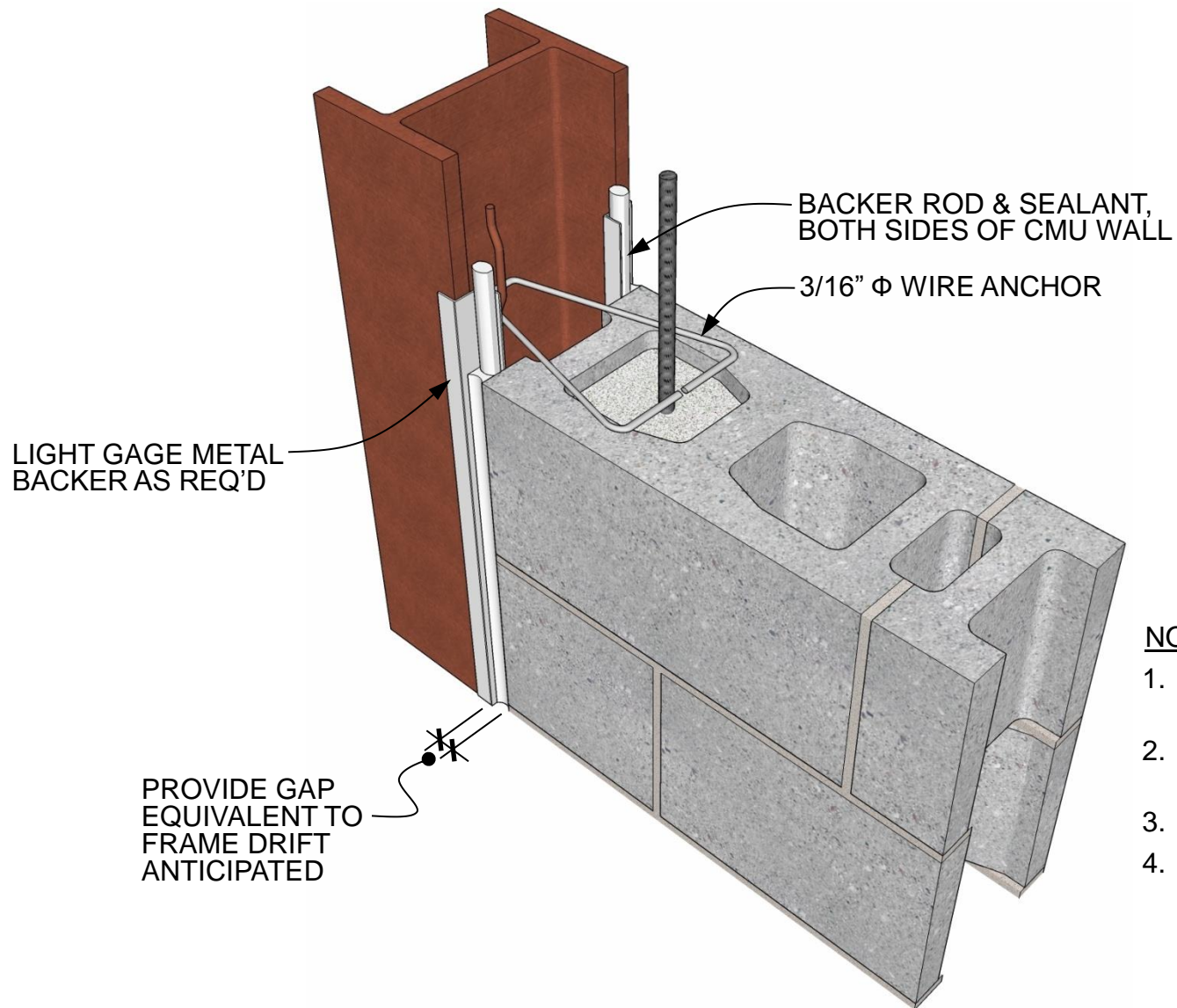

FIG. 6  
IMI TECH BRIEF 02.13.02



NOTES

1. FOR FIRE-RATED CONSTRUCTION, USE FIRE-RATED SEALANT
2. FIREPROOFING FOR STEEL NOT SHOWN
3. APPLIES TO TYPE I AND II HYBRID
4. TYPE III HYBRID WOULD REQUIRE FULL BEARING AT STEEL INTERFACES WITH COLUMNS & BEAMS

COLUMN CONNECTION DETAIL

DETAIL 02.120.1103

REV. 07/24/09

International Masonry Institute



800-IMI-0988 [www.imiweb.org](http://www.imiweb.org)

© 2011 INTERNATIONAL MASONRY INSTITUTE