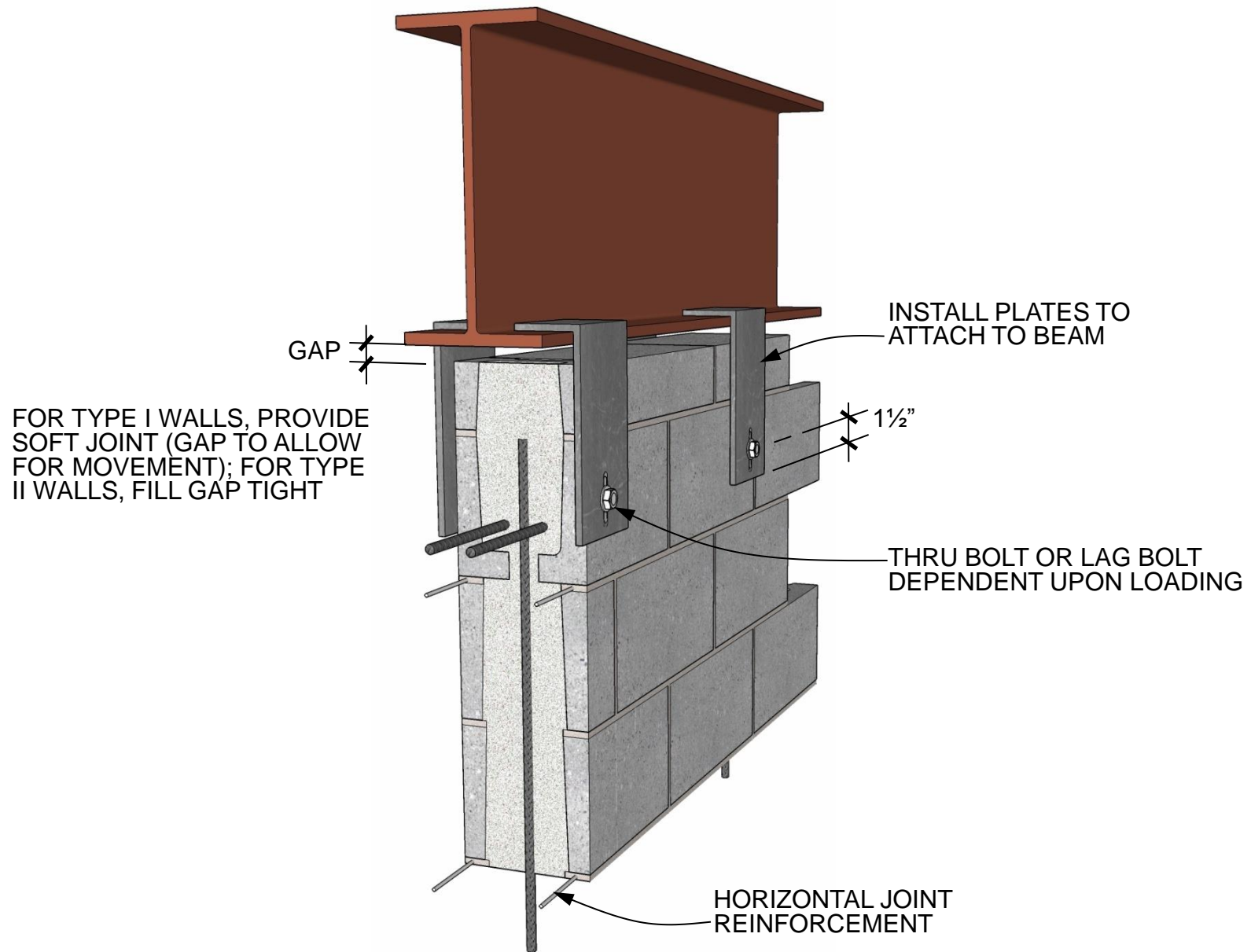

FIG. 5  
IMI TECH BRIEF 02.13.02



**TOP OF WALL DETAIL** HYBRID TYPE I & II  
DETAIL 02.120.0801 REV. 07/27/09

International Masonry Institute



800-IMI-0988 [www.imiweb.org](http://www.imiweb.org)

© 2011 INTERNATIONAL MASONRY INSTITUTE