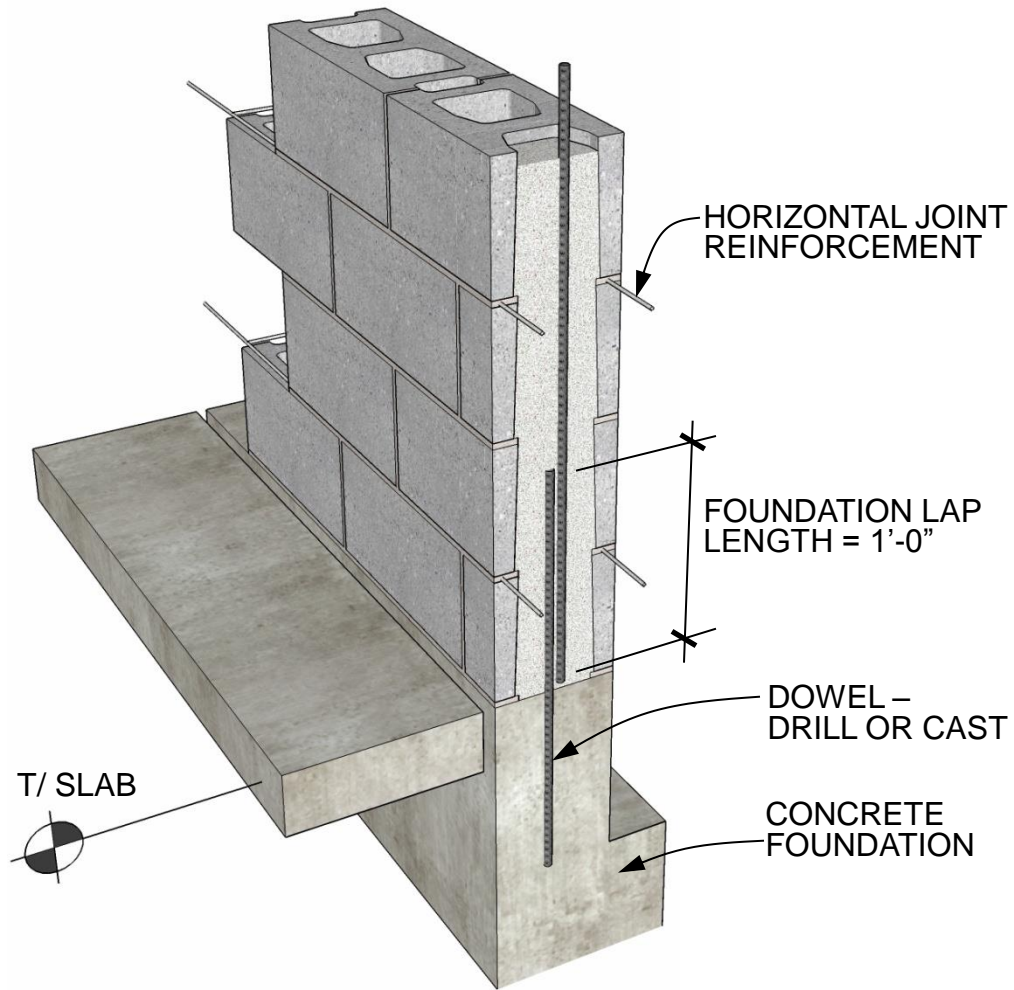

FIG. 3  
IMI TECH BRIEF 02.13.02



# FOUNDATION DETAIL

HYBRID TYPE IIb

DETAIL 02.120.0302

REV. 07/24/09

International Masonry Institute



800-IMI-0988 [www.imiweb.org](http://www.imiweb.org)

© 2011 INTERNATIONAL MASONRY INSTITUTE