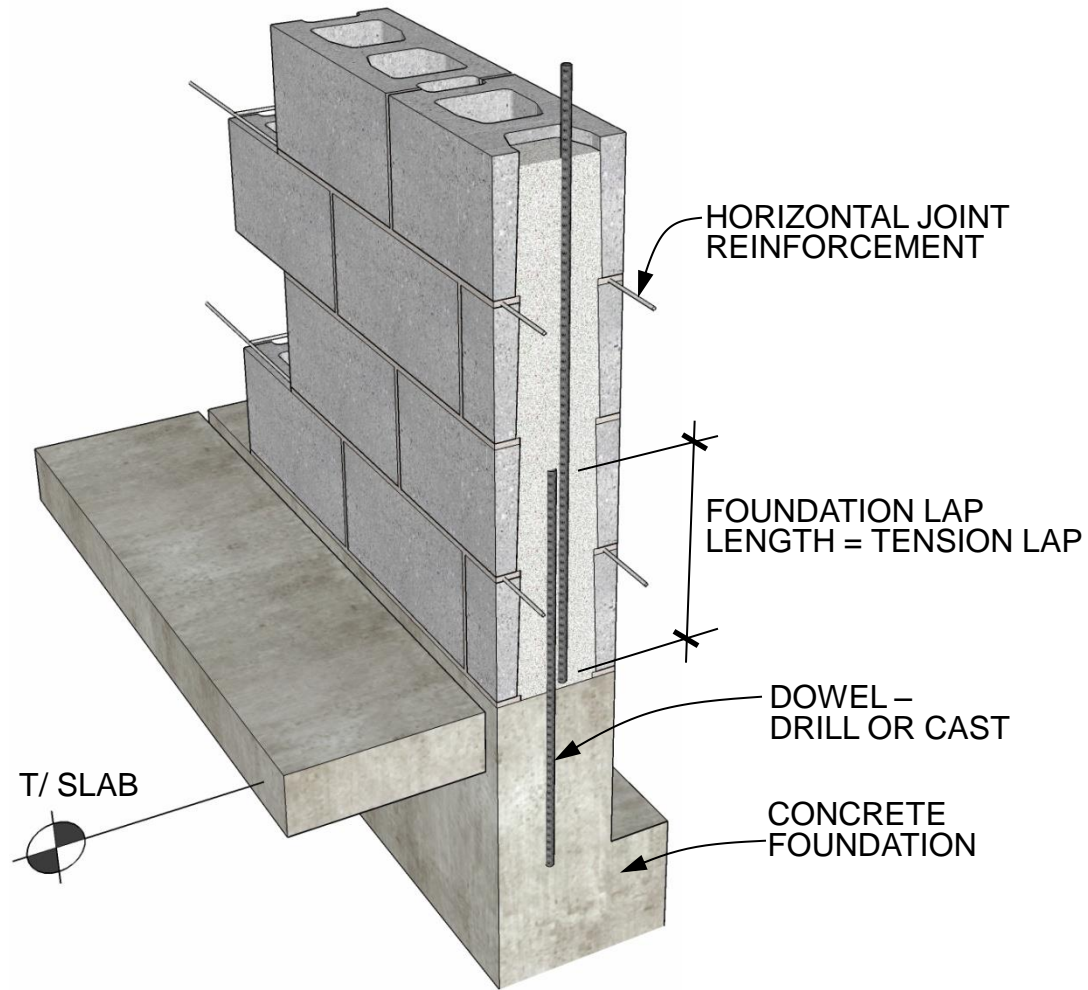

FIG. 1  
IMI TECH BRIEF 02.13.02



**FOUNDATION DETAIL**    HYBRID TYPE I & IIa  
DETAIL 02.120.0301                      REV. 07/24/09

International Masonry Institute



800-IMI-0988    www.imiweb.org

© 2011 INTERNATIONAL MASONRY INSTITUTE